

# COLUMBUS COMMONS

155 WEST MILLS STREET, COLUMBUS, NC 28722



## PROPERTY SUMMARY

Columbus, North Carolina is located in the beautiful foothills of the Blue Ridge Mountains, and is conveniently located on Interstate 26, about 30 minutes from Asheville and 90 minutes from Charlotte

- ♦ Average Household Incomes: 1 mile \$55,453 / 3 mile \$60,204 / 5 mile \$63,344
- ♦ Population: 1 mile 1,822 / 3 mile 4,867 / 5 mile 11,139
- ♦ Directly off of I-26 exit ramp beside I-26 and HWY 74 intersection
- ♦ I-26 traffic count 27,000 VPD & HWY 74 17,000 VPD
- ♦ Property sits on 3.25 acres
- ♦ 130 designated parking spaces
- ♦ Both east and west entry/exit



Leasing Inquiries: Sam Spiegel 954.429.9000 x14 | [sam@samcoproperties.com](mailto:sam@samcoproperties.com)

## TENANT SUMMARY

Tenant	Sq.Ft.
101 Green River Tavern	1,569
102 Joy Wok	1,258
103 VACANT	1,255
104 Edward Jones	1,255
105 H&R Block	1,255
106 McEntire Ins. Agency	1,255
107 JK Nails	1,255
108 Hospice of Rutherfordton	1,882
109 Purrrfect Bark	1,695
110 VACANT	2,441
111 VACANT	2,441
112-114 Mel & Lo's Bar & Grill	4,412
201-202 VACANT	4,141
203-204 Premier Pain Solutions	4,141

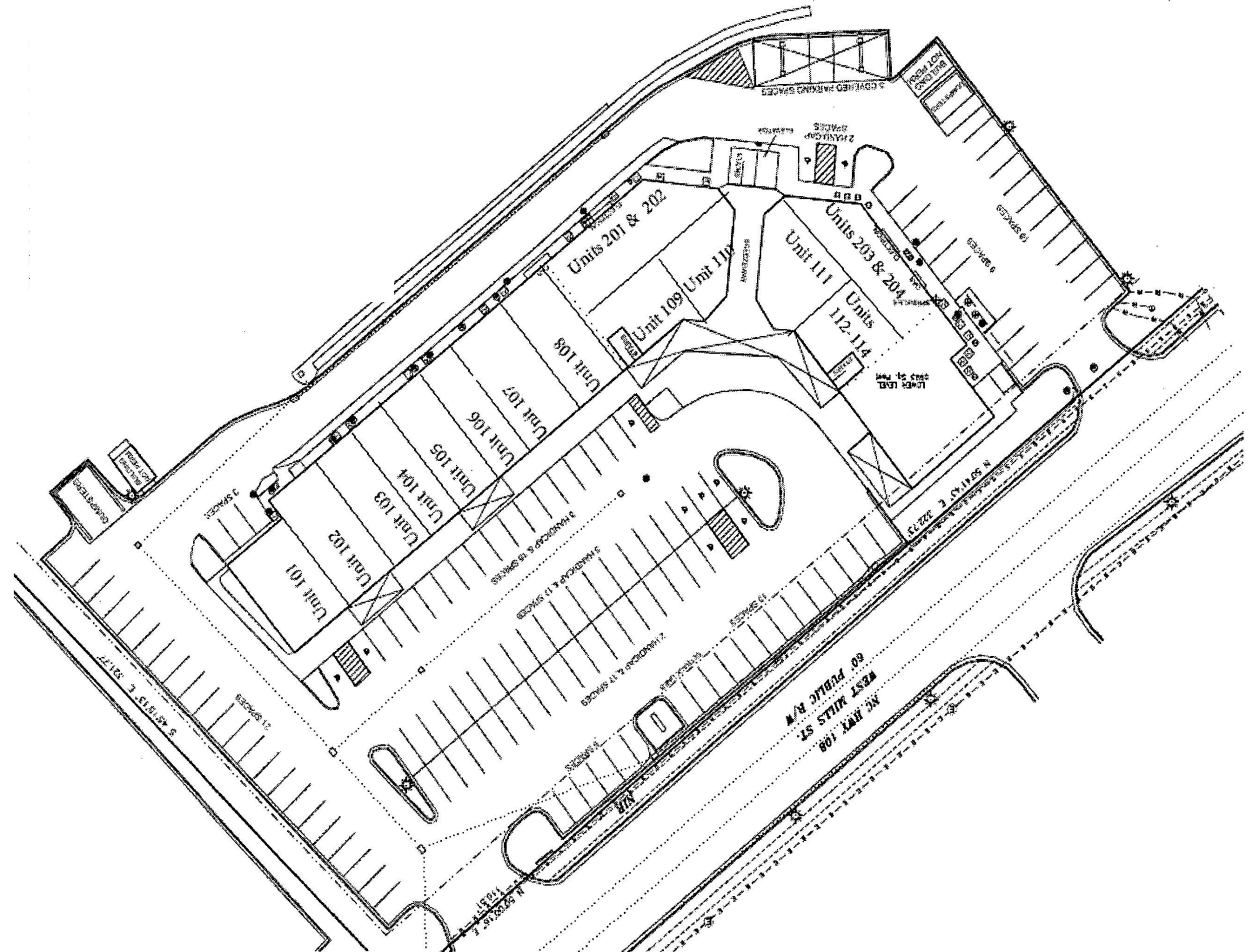

## PROPERTY HIGHLIGHTS

- Located in Columbus Commons, a busy retail hub with daily trips and surrounded by many new developments
- 13,000 Vehicles Per Day on this gateway thoroughfare from I-26
- Suite 103: great visibility, and current layout works well for retail in the front and office or storage in the back
- Suites 110 and 111: ideal for professional services or a variety of retail; Suite 111 has a roll-up door at the back

- Columbus Commons contains a variety of retail, medical, and other professional services
- Neighbors include a O'Reilly Auto Parts, Bojangles, Mercy Urgent Care, Advance Auto Parts, CVS, Entegra Bank, Wendy's Food Lion, St. Luke's Hospital Medical Building, and numerous service and professional businesses
- Well-maintained center, elevator access to second floor, railings for patients, highly-visible signage out front





MAP

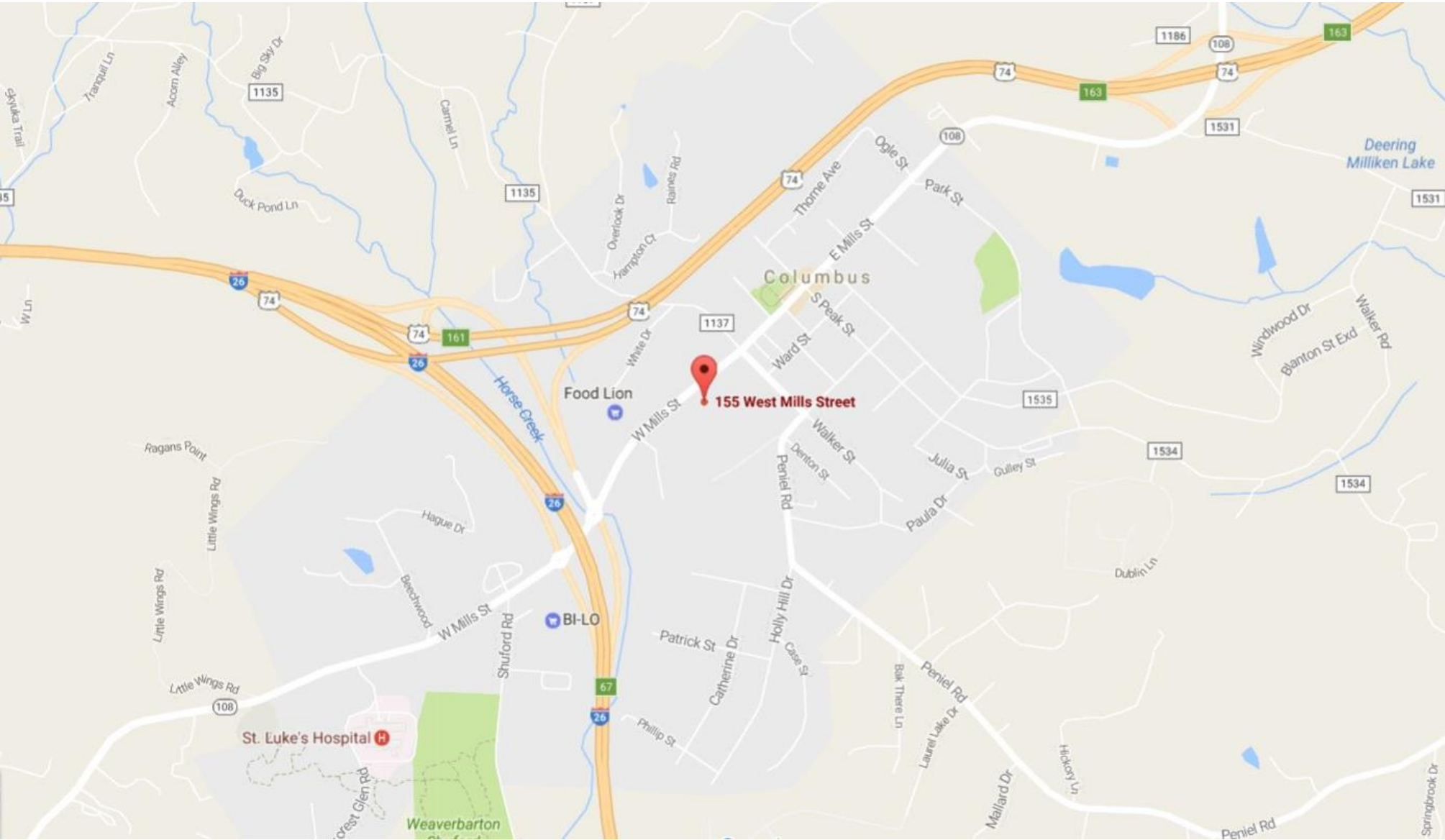



PHOTOS



Suite 110 Store Front



Breezeway



Stairs and elevator



Ample Parking

